

METAL HOOD SPECIFICATION SHEET

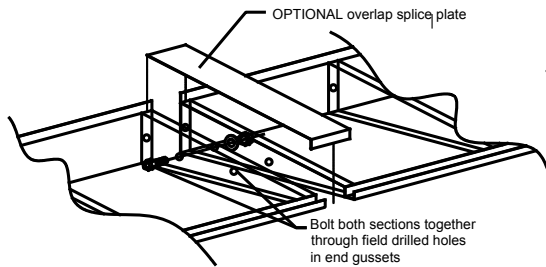

NOTE: FOR WIDER DOOR COVERAGE, TWO HOODS CAN BE CONNECTED TOGETHER WITH AN OVERLAP SPLICE PLATE (OPTIONAL)

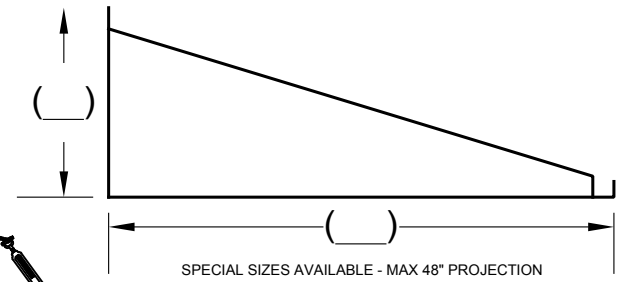
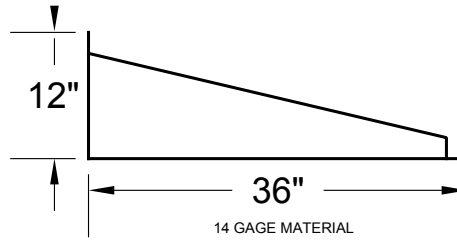
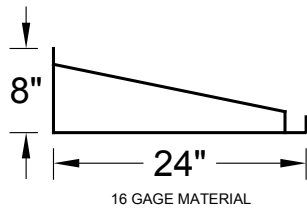
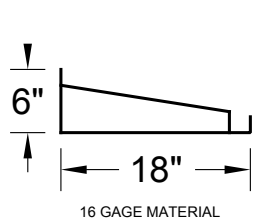
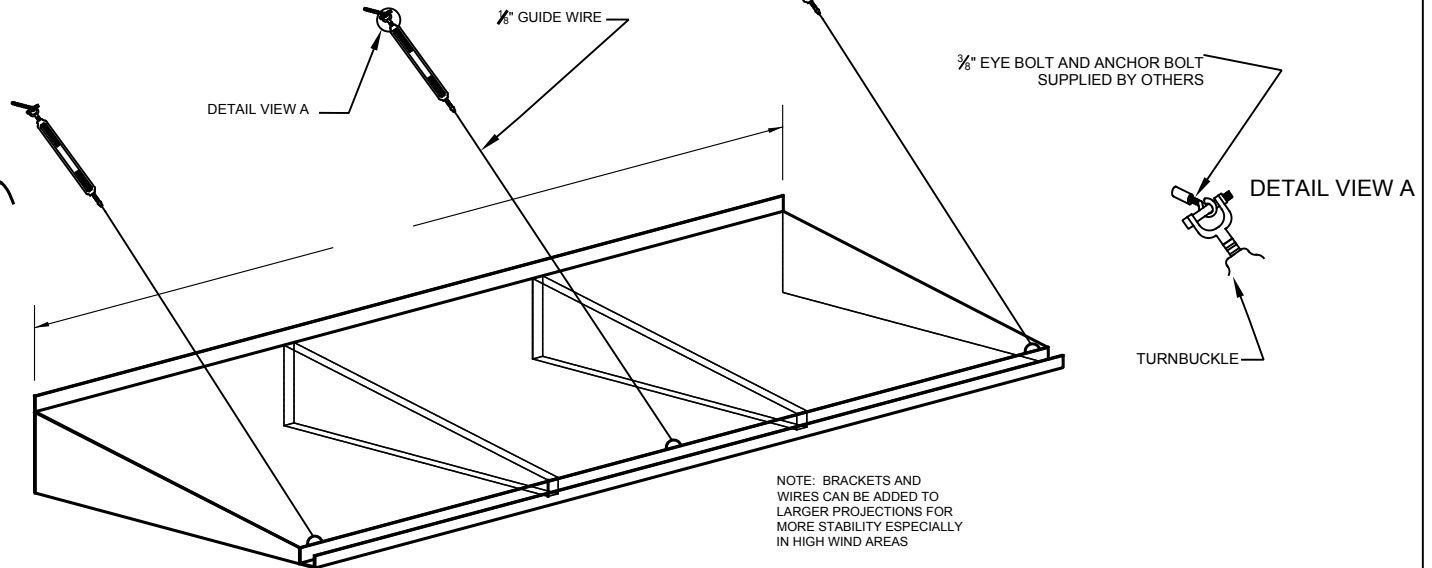

NOTE: BRACKETS AND WIRES CAN BE ADDED TO LARGER PROJECTIONS FOR MORE STABILITY ESPECIALLY IN HIGH WIND AREAS

MOUNTING OPTIONS

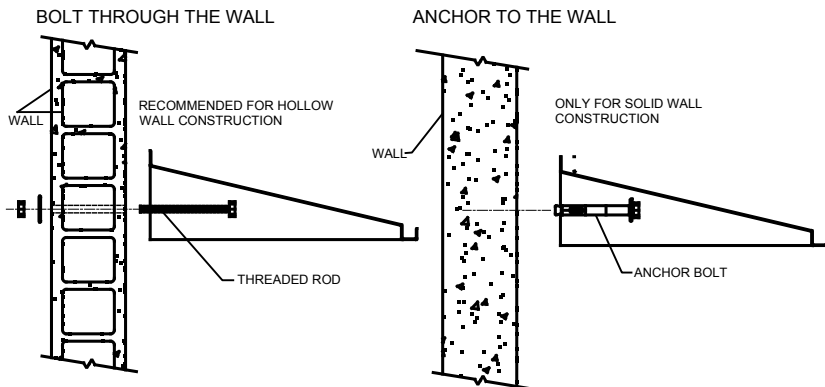

QUANTITY: _____
SIZE:

- _____" L x 18" PROJ. x 6" H
- _____" L x 24" PROJ. x 8" H
- _____" L x 36" PROJ. x 12" H

SPECIAL DOOR SIZE: _____" L x _____" PROJ. x _____" H

GUSSET PER LENGTH		TABS PER LENGTH	
2	1'-5'	2	1'-5'
3	6'-7'	3	6'-9'
4	8'-10'	4	10'-12'
5	10'-11'		

SPECIAL INFORMATION

PERMA TECH, INC.
363 HAMBURG STREET • BUFFALO, NY 14204
(716) 854-0707 • 1-800-DOC-SEAL

JOB: _____

DEALER: _____

CONTRACTOR: _____ QUOTE: _____

APPROVED BY SIGNATURE: _____