

# GROUND LEVEL DOCK SHELTER SPECIFICATION SHEET

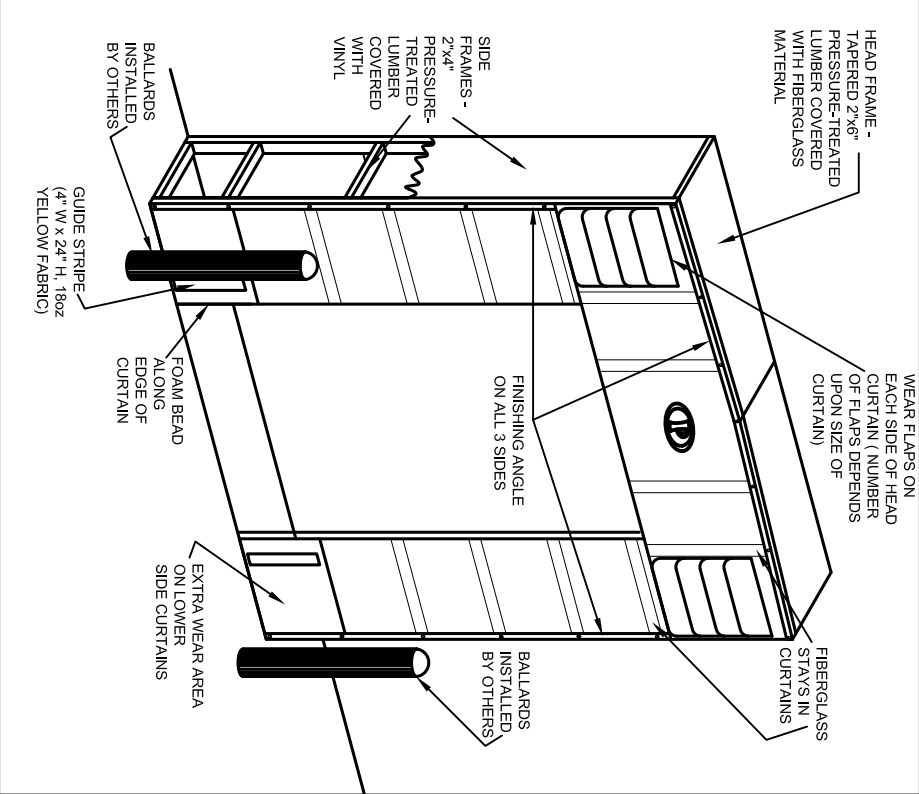

STANDARD

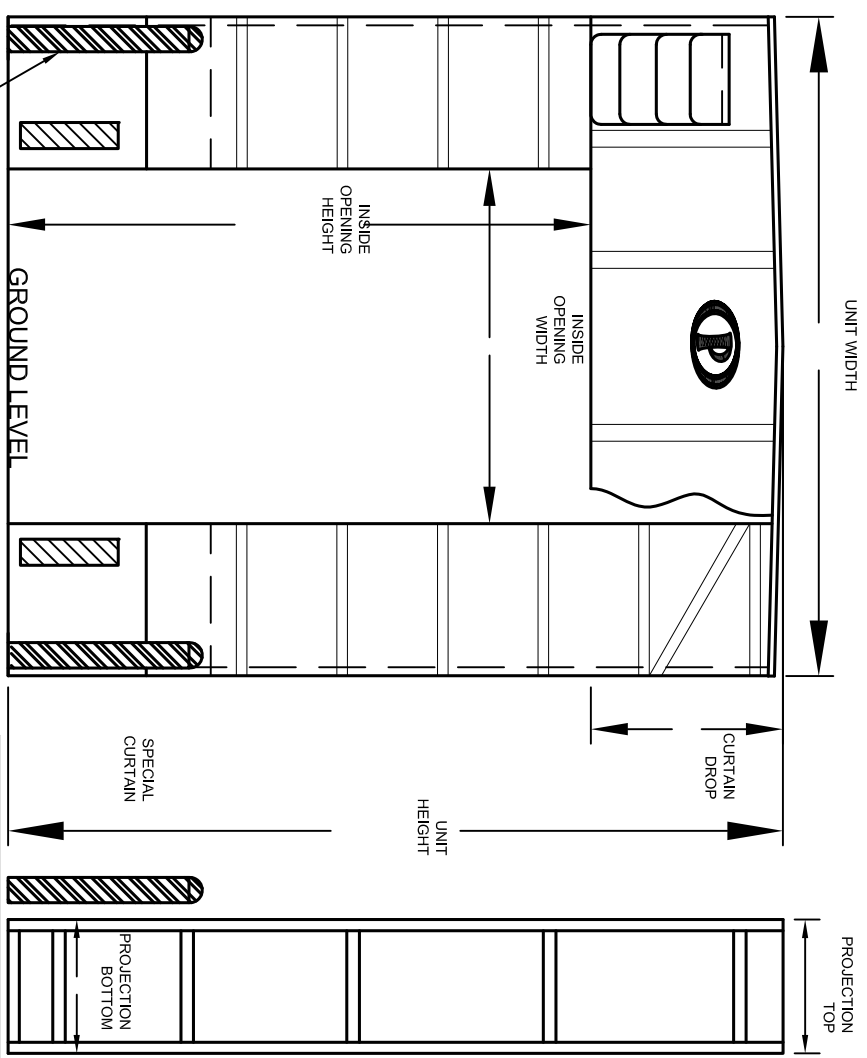
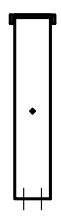

STEEL BUMBERS

TYPE II

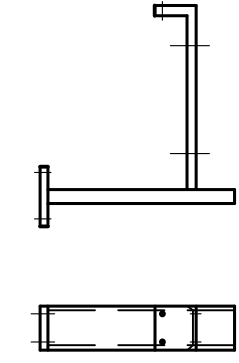
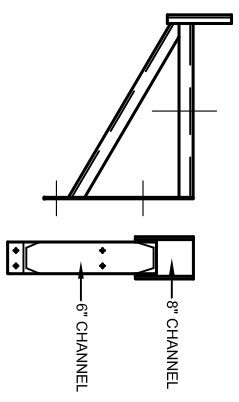

QUANTITY: \_\_\_\_\_, MODEL: \_\_\_\_\_

UNIT SIZE: \_\_\_\_\_ WIDTH, \_\_\_\_\_ HEIGHT  
 HEAD CURTAIN: \_\_\_\_\_ WIDTH, \_\_\_\_\_ DROP

INSIDE OPENING WIDTH: \_\_\_\_\_

INSIDE OPENING HEIGHT: \_\_\_\_\_  
 PROJECTION: \_\_\_\_\_ TOP, \_\_\_\_\_ BOTTOM

CHAIN FLAP: \_\_\_\_\_ WIDTH, \_\_\_\_\_ HEIGHT

FACE FABRIC: \_\_\_\_\_ COLOR: \_\_\_\_\_

DOOR SIZE: \_\_\_\_\_ WIDTH, \_\_\_\_\_ HEIGHT

DOCK HEIGHT: \_\_\_\_\_

APPROACH: \_\_\_\_\_

OPTIONS: UNIT SUPPORT FRAME:  WOOD  STEEL

## SPECIAL INFORMATION

JOB: \_\_\_\_\_

DEALER: \_\_\_\_\_ DATE: \_\_\_\_\_

CONTRACTOR: \_\_\_\_\_ QUOTE #: \_\_\_\_\_

APPROVED BY SIGNATURE: \_\_\_\_\_

