

METAL HOOD SPECIFICATION SHEET

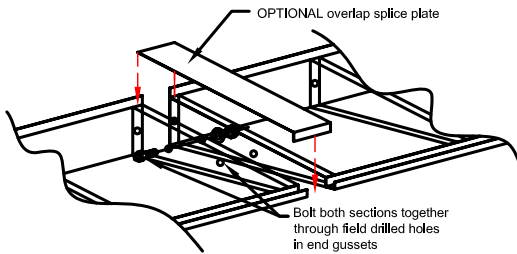

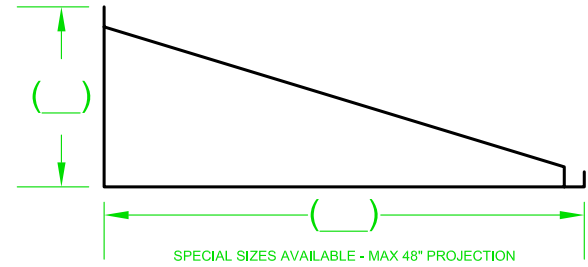

NOTE: FOR WIDER DOOR COVERAGE, TWO HOODS CAN BE CONNECTED TOGETHER WITH AN OVERLAP SPLICE PLATE (OPTIONAL)

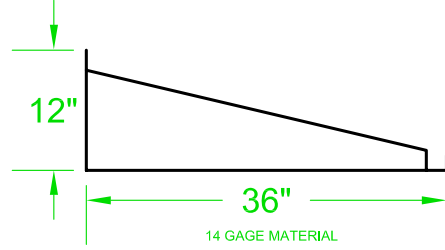
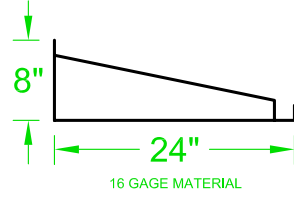
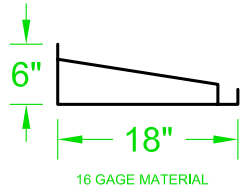
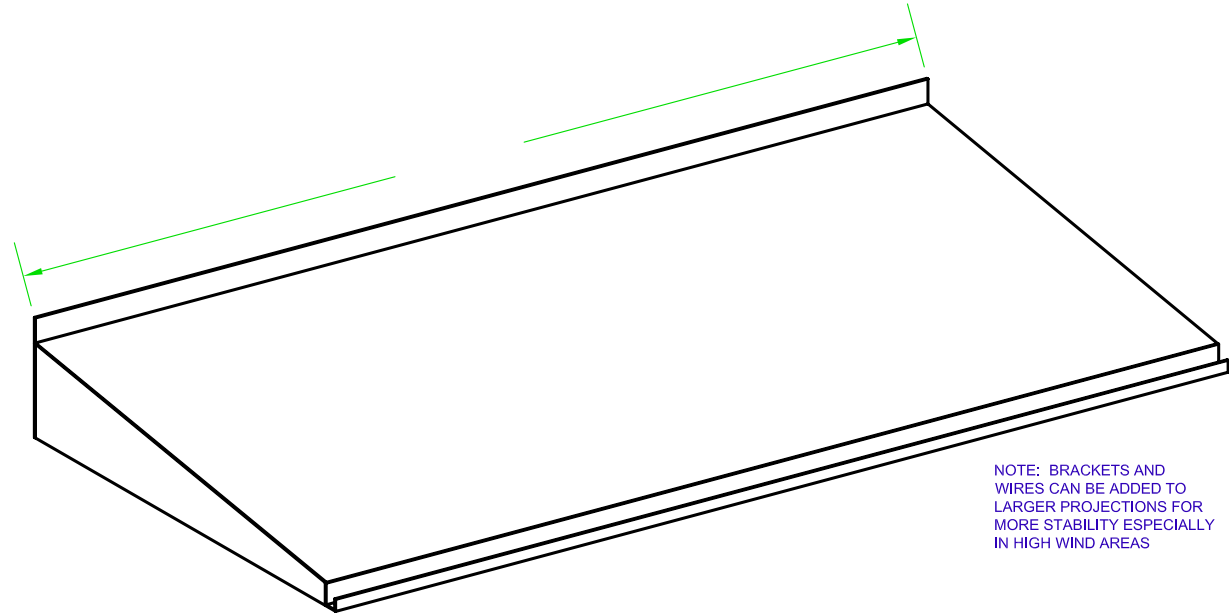

NOTE: BRACKETS AND WIRES CAN BE ADDED TO LARGER PROJECTIONS FOR MORE STABILITY ESPECIALLY IN HIGH WIND AREAS

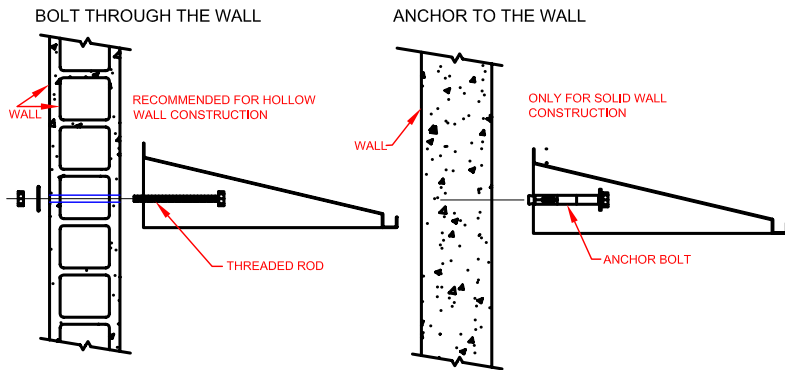
MOUNTING OPTIONS



QUANTITY: _____ SIZE: <input type="checkbox"/> _____ L x 18" PROJ. x 6" H <input type="checkbox"/> _____ L x 24" PROJ. x 8" H <input type="checkbox"/> _____ L x 36" PROJ. x 12" H SPECIAL DOOR SIZE: _____" L x _____" PROJ. x _____" H	 PERMA TECH, INC. 363 HAMBURG STREET • BUFFALO, NY 14204 (716) 854-0707 • 1-800-DOC-SEAL www.permatechinc.com
SPECIAL INFORMATION	
JOB:	
DEALER:	
CONTACT:	QUOTE # :
APPROVED BY SIGNATURE:	